



**Features:**  
Gateways/hubs Gledopto zigbee products Directly work with: HUE, Amazon echo plus, SmartThings, Homee etc  
Via Hue gateway, can work with google home, all other alexa devices

**App work with Hue gateway:**  
Hue, hue essential, hueparty, hue Disco, iConnectHue, Hue Widget, Light DJ, etc

**Work with Home Assistant:**  
<http://bitly.ws/dELh>

**Work with Homekit:**  
<http://bitly.ws/ejZY>

**Sync effect with screenbloom:**  
Sync your lights with movies, music, and games. Enjoy the lighting effect which synchronizes with the plot of the picture immediately, and experience the more delicate atmosphere lighting effect.

**How to sync?**  
Please follow this website: <http://www.screenbloom.com/>  
Sync Show Demo: [https://youtube/zZjtJMy\\_774](https://youtube/zZjtJMy_774)

Q&A or more info, please go to: [www.gledopto.com](http://www.gledopto.com) or email to [sales@gledopto.com](mailto:sales@gledopto.com), or [https://www.reddit.com/r/Gledopto\\_Support](https://www.reddit.com/r/Gledopto_Support)

**RGB+CCT Remote Control (GL-RC-006Z)**  
This manual describes RGB+CCT remote control used for our RGB+CCT products. Remote control can control the LED lights up to six different Zones, change the color, dim/brighten the lights, warm/cool white, different programs. In this manual, you will learn.

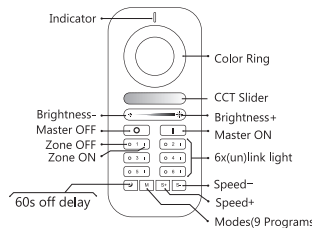

**Battery Installation**  
Please take the remote control and carefully press the battery cover and push it away in a downward motion. Install two AAA batteries, exactly match the negative (-) pole of each battery to the largest spring. Don't touch the color ring when you install the batteries. Place the battery cover back and install tightly.

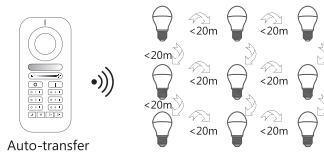

**EC REP**  
**LED-Trading Tobias Ebert**  
Schoeneicher Str. 42, Schoeneiche b. Berlin, Germany, 15566  
0049 30 641 689 17 [info@led-trading.de](mailto:info@led-trading.de)

**How to link & use with remote control**

1. Within 3 seconds after the light power on, click the "on" button in the group to perform code matching. The LED light turns green means successful code matching.
2. Long presses the "off" button of the remote control to enter the night mode, and the brightness and color can still be adjusted at this time.
3. Long presses the small moon key to enter the 60 seconds delay shutdown state.
4. Click the "M" key to enter automatic mode.

**How to unlink**

1. Within 4s of powering on the light, press the "main on" button 5 times continuously, and the light flashes, indicating that the light is unpaired from all the remote controls that have been coded, and will not be controlled by any remote control.
2. Within 4s of powering on the light, press the paired "group on" button 5 times continuously, and the light flashes, indicating that the light is unpaired from the remote control and will not be controlled by the remote control. Other paired remote controls can still be controlled.

**Mode description**

Mode 1: Static warm light (warm light alone)

Mode 2: Static white light (cold light and warm light are equally bright)

Mode 3: Static cold light (cold light alone)

Mode 4: Static red light

Mode 5: Static green light

Mode 6: Static blue light

Mode 7: RGB fade in fade out (Color fade in fade out from red to green, then to blue, then to red, and so on, speed adjustable.)

Mode 8: RGB flash (Color flash from red to green, then to blue, then to red, and so on, speed adjustable.)

Mode 9: Color breathing (In this mode, the brightness of current color will cycle from from 100%-0%, then from 0%-100%. At the same time, you can switch the color and have a cycle repeatedly. Pressing switch /mode button to exit this mode.)

**How to link & use with zigbee hub**  
These devices works with many ZigBee Light Link /ZigBee 3.0 Gateways like Philips Hue, Amazon Echo Plus or SmartThings.

**Installation:**

1. Turn off the Power.
2. Plug in the Bulb.
3. Now you can connect it with the gateway.

**Connection with Gateway:**

1. Start the device searching on the ZigBee Light Link /ZigBee 3.0 Gateway, it could take some time. If the Gateway does not find the device, plug power off/on or make a reset.
2. After finding the device, the light will turn green, then you can save it to the rooms/groups.
3. Now you can use the device.

**Reset:**

1. Switch on your device.
2. Now switch off and on within 2 seconds.
3. Repeat off/on five times.
4. Reset is done when the device is switched on in the fifth time and the LED light will be fully bright and flashing for 4 times.

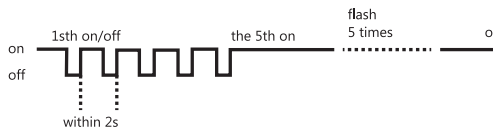

## Compability Chart

Gateways	Philips Hue	Amazon Echo Plus	Smart Things	IKEA Tradfri	Conbee	Terncy	Homee	Smart Friends
Item	①	②	③	④	⑤	⑥	⑦	⑧
RGB+CCT	Yes/Ja	Yes/Ja	Yes/Ja	/	Yes/Ja	Yes/Ja	Only/nur RGB	Yes/Ja
RGBW	Yes/Ja	Yes/Ja	Yes/Ja	/	Yes/Ja	Yes/Ja	Yes/Ja	Only/nur RGB
CCT	Yes/Ja	Yes/Ja	Yes/Ja	Only Dimmable	Yes/Ja	Yes/Ja	einzelfarbe single color	Yes/Ja
Dimmer	Yes/Ja	Yes/Ja	Yes/Ja	Yes/Ja	Yes/Ja	Yes/Ja	Yes/Ja	Yes/Ja

\*\*\*  
①②③④⑤⑥ are already tested by GLEDOPTO, ⑦⑧ are from our customers, just for your information, not verified by GLEDOPTO.

## RGB+CCT Spotlight

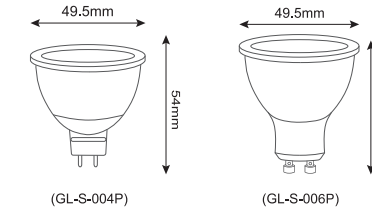

### Parameter

Product model	GL-S-004P	GL-S-006P
Input voltage	AC/DC12V(MR16)	AC100~240V(GU10)
Power	4W	5W
Color temperature	2200-6500K	
Luminous Flux	250~300LM	300~450LM
Beam angle	25°	30°
Housing	Aluminum+Plastic	
Working Temp	-20°C~60°C	
CRI	>80	
LED Quantity	1.5W RGB 5050 2pcs 1.0W 3030 6pcs	1.5W RGB 3030 2pcs 1.0W 3030 8pcs

**Features:**

1. Compatible with ZIGBEE hub, APP control, Voice control.
2. Wireless 6-Zone touch remote control, control distance at least 20 meters.
3. 16 million colors change, dimmable from 1% to 100%.
4. Color temperature from 2200K to 6500K.
5. Saturation control—White and RGB.
- 6' 60s off delay.

**Attention:**

1. Link the lightbulb with the remote control or the smart phone App before use.
2. Make sure the voltage is between AC100~240V or AD/DC12V.
3. Avoid using under high temperature or moisture.
4. Make sure the power is off before installation.

## RGB+CCT Bulb

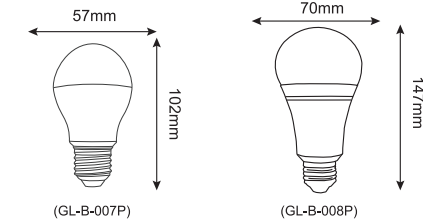

### Parameter

Power:6W  
Baes:E27/E26/B22  
Input Voltage:AC 100~240V  
Color temperature:2200-6500K  
Luminous Flux:500-550LM  
Light Efficiency:90LM/W  
Life span:50000h  
Working Temp:-20~60 degrees  
Material:Aluminum housing+PC Cover

Power:12W  
Baes:E27/E26  
Input Voltage:AC 100~240V  
Color temperature:2200-6500K  
Luminous Flux:900-1100LM  
Light Efficiency:90LM/W  
Life span:50000h  
Working Temp:-20~60 degrees  
Material:Aluminum housing

### Parameter

Power:4W  
CRI:>80  
PF:>0.5  
Lifespan:50000 hours  
Input voltage : AC100~240V  
Color temperature:2200~6500K  
Luminous Flux : 250~300LM  
Working Temp : -20°C~60°C  
Housing : Plastic + Aluminum  
Size : Φ37.5\*103.5mm(E12)  
Φ37.5\*110mm(E14)

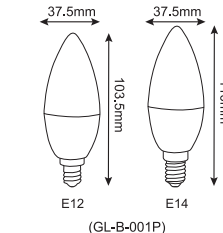

## LED Filament Bulb

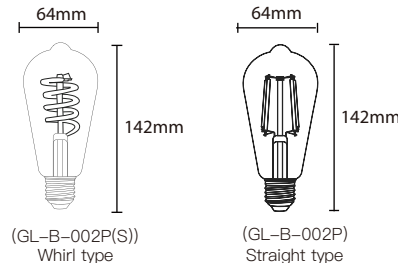

### Parameter

Power: 7W  
Shape: ST64  
Model: GL-B-002P(S)  
Size:  $\Phi 64 \times 142 \text{mm}$   
N.W.: 47.0g  
G.W.: 89.4g  
Input Voltage: AC 220~240V  
Input Current: 60mA Max 50Hz  
Color Temperature: 1800k~6500k  
Luminous Flux: 520LM~680LM  
Working Temp:  $-20^{\circ}\text{C} \sim 45^{\circ}\text{C}$   
Zigbee Distance: >50m  
RF Distance: >30m  
CRI: >80  
Material: Aluminum+Glass

### Parameter

Power: 7W  
Shape: ST64  
Model: GL-B-002P  
Size:  $\Phi 64 \times 142 \text{mm}$   
N.W.: 45.3g  
G.W.: 87.7g  
Input Voltage: AC 220~240V  
Input Current: 60mA Max 50Hz  
Color Temperature: 2200k~6500k  
Luminous Flux: 800LM  
Working Temp:  $-20^{\circ}\text{C} \sim 45^{\circ}\text{C}$   
Zigbee Distance: >50m  
RF Distance: >30m  
CRI: >80  
Material: Aluminum+Glass

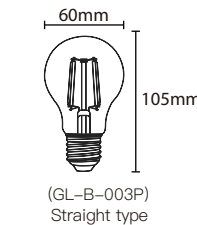

### Parameter

Power: 7W  
Shape: A60  
Model: GL-B-003P  
Size:  $\Phi 60 \times 105 \text{mm}$   
N.W.: 35.7g  
G.W.: 66.9g  
Input Voltage: AC 220~240V  
Input Current: 60mA Max 50Hz  
Color Temperature: 2200k~6500k  
Luminous Flux: 800LM  
Working Temp:  $-20^{\circ}\text{C} \sim 45^{\circ}\text{C}$   
Zigbee Distance: >50m  
RF Distance: >30m  
CRI: >80  
Material: Aluminum+Glass

### Parameter

Power: 7W  
Shape: A60  
Model: GL-B-003P(S)  
Size:  $\Phi 60 \times 105 \text{mm}$   
N.W.: 37.4g  
G.W.: 68.6g  
Input Voltage: AC 220~240V  
Input Current: 60mA Max 50Hz  
Color Temperature: 1800k~6500k  
Luminous Flux: 520LM~680LM  
Working Temp:  $-20^{\circ}\text{C} \sim 45^{\circ}\text{C}$   
Zigbee Distance: >50m  
RF Distance: >30m  
CRI: >80  
Material: Aluminum+Glass

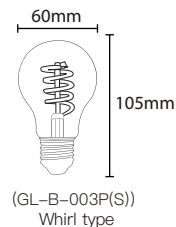

(GL-B-003P(S))  
Whirl type

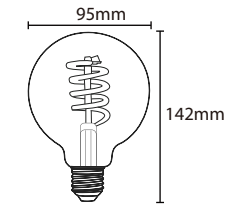

(GL-B-004P(S))  
Whirl type

### Parameter

Power: 7W  
Shape: G95  
Model: GL-B-004P(S)  
Size:  $\Phi 95 \times 142 \text{mm}$   
N.W.: 61.2g  
G.W.: 119.0g  
Input Voltage: AC 220~240V  
Input Current: 60mA Max 50Hz  
Color Temperature: 1800k~6500k  
Luminous Flux: 520LM~680LM  
Working Temp:  $-20^{\circ}\text{C} \sim 45^{\circ}\text{C}$   
Zigbee Distance: >50m  
RF Distance: >30m  
CRI: >80  
Material: Aluminum+Glass

### Power on status:

Power on and off for 3 times and the light will flash for 2 times, then the light will remember the on/ off status. Repeat the operation again to cancel this function, the light will be on by default when powered on. This function only applies to Filament Bulb.

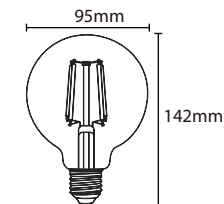

(GL-B-004P)  
Straight type

### Parameter

Power: 7W  
Shape: G95  
Model: GL-B-004P  
Size:  $\Phi 95 \times 142 \text{mm}$   
N.W.: 59.5g  
G.W.: 117.3g  
Input Voltage: AC 220~240V  
Input Current: 60mA Max 50Hz  
Color Temperature: 2200k~6500k  
Luminous Flux: 800LM  
Working Temp:  $-20^{\circ}\text{C} \sim 45^{\circ}\text{C}$   
Zigbee Distance: >50m  
RF Distance: >30m  
CRI: >80  
Material: Aluminum+Glass

## RGB+CCT Downlight

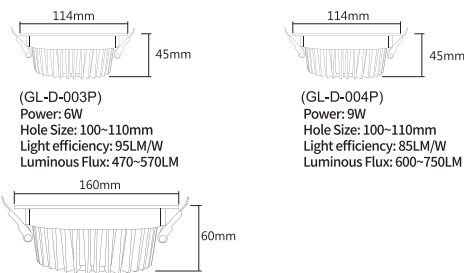

(GL-D-003P)  
Power: 6W  
Hole Size: 100~110mm  
Light efficiency: 95LM/W  
Luminous Flux: 470~570LM

(GL-D-004P)  
Power: 9W  
Hole Size: 100~110mm  
Light efficiency: 85LM/W  
Luminous Flux: 600~750LM

(GL-D-005P)  
Power: 12W  
Hole Size: 140~150mm  
Light efficiency: 100LM/W  
Luminous Flux: 1000~1200LM

### Parameter

CRI: >80  
PF>0.5  
Lifespan: 50000hours  
Beam Angle: 120°

SDCM: <5  
Input Voltage: AC 100~240V  
Color temperature: 2200~6500K  
Material: Aluminum+PC Cover

1. Please open the hole on the ceiling according to the correct size of Diagram 1.
2. Push in the two spring elements, make sure that they are deployed and anchored on the back of the ceiling Diagram 2 and 3.
3. Connect the driver properly according to the wire connection Diagram 4.

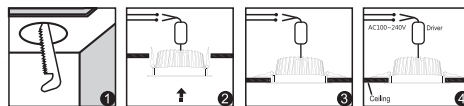

## RGB+CCT Downlight (IP54)

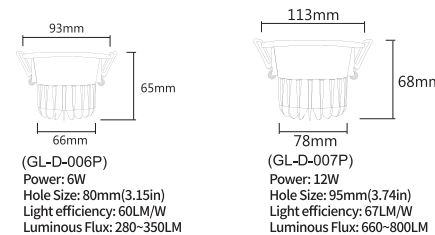

(GL-D-006P)  
Power: 6W  
Hole Size: 80mm(3.15in)  
Light efficiency: 60LM/W  
Luminous Flux: 280~350LM

(GL-D-007P)  
Power: 12W  
Hole Size: 95mm(3.74in)  
Light efficiency: 67LM/W  
Luminous Flux: 660~800LM

### Parameter

CRI: >80  
PF>0.5  
Lifespan: 50000hours  
Beam Angle: 60°

SDCM: <5  
Input Voltage: AC 100~240V  
Color temperature: 2200~6500K  
Material: Aluminum+PC Cover

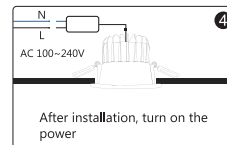
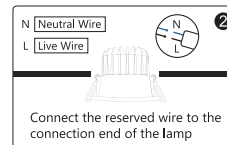
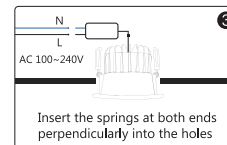
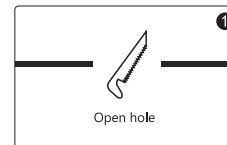

## RGB+CCT Downlight (CRI>90)

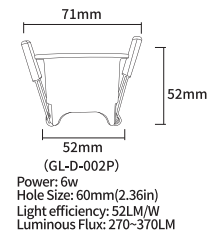

(GL-D-002P)  
Power: 6w  
Hole Size: 60mm(2.36in)  
Light efficiency: 52LM/W  
Luminous Flux: 270~370LM

### Parameter

CRI: >90  
PF>0.5  
Lifespan: 50000hours  
Beam Angle: 60°

SDCM: <5  
Input Voltage: AC 100~240V  
Color temperature: 2200~6500K  
Material: Aluminum+PC Cover

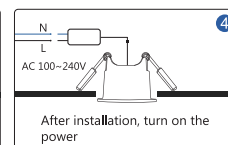
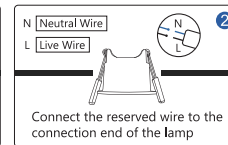
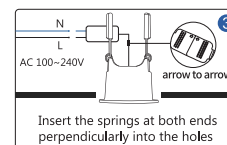
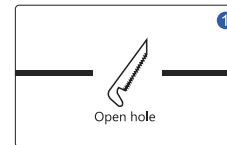

Attention

1. Please check whether the input voltage of the constant voltage power supply is in accordance with the Lamps, and please check the connection of both the cathode and anode.
2. The working Voltage is AC100-240V, the Lamps will be broken if the voltage is higher than 240V.
3. Non-professional user cannot dismantle the Lamps directly, otherwise, it may cause fire and electric shock.
4. The working temperature is  $-20 \sim 45^{\circ}\text{C}$ ; Do not use the device to direct sunlight, moist and other high temperature area.
5. Please do not use Lamps around the mental area and high magnetic field, otherwise, it will badly affect the Use effect.

## Disclaimers

- \* This manual may contain inaccuracies or discrepancies of the product operations, or typographical errors. Our company will update the contents of this manual according to the improvements and changes of product functions, and regularly improve and update the software and hardware of products described in this manual. The updates will be shown in the latest edition of this manual without further notice.
- \* Due to the continuous adoption of new technologies by our company, the product parameters will be changed without any notice in prior.
- \* This manual is only for reference and guidance for customers. It does not guarantee that it is completely consistent with the actual product. The actual application is subject to the actual product.
- \* The parts, components and accessories mentioned in this manual do not represent the standard configuration of the product. The detailed configuration is subject to the packing list.
- \* All texts, tables and pictures in this manual are protected by the relevant national laws, and may not be used without permission by supplier.
- \* The copyright and right of the final interpretation of this manual are reserved by our company.